

## Anglesea Terrace, St. Leonards-On-Sea TN38 0QS

Offers in excess of £225,000



A well presented TWO BEDROOM APARTMENT with an attractive outlook towards the sea. It's enviably positioned within CENTRAL ST LEONARDS and just a short stroll from the mainline railway station, local shops and award winning eateries. Spanning the second floor of this period residence the accommodation here is arranged as a BRIGHT LIVING ROOM which measures 15'11 x 11'10 with two large windows framing a southerly aspect. The SEPARATE KITCHEN overlooks the living space and is fitted to offer ample storage and worktop space. There are two bedrooms, with the principal bedroom positioned at the rear of the property benefitting from BUILT-IN STORAGE, together with a family bathroom where there is a bath with shower and screen over. Being sold with NO ONWARD CHAIN this fantastic property would make the perfect first time home or seaside retreat.

SECOND FLOOR  
683 sq.ft. (63.4 sq.m.) approx.

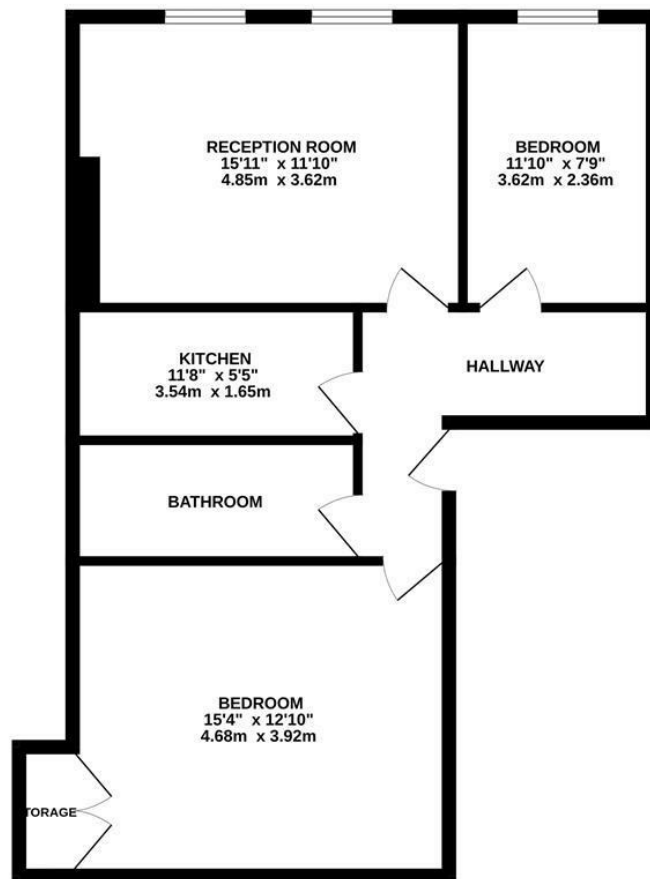

TOTAL FLOOR AREA : 683 sq.ft. (63.4 sq.m.) approx.

Whilst every attempt has been made to ensure the accuracy of the floorplan contained here, measurements of doors, windows, rooms and any other items are approximate and no responsibility is taken for any error, omission or mis-statement. This plan is for illustrative purposes only and should be used as such by any prospective purchaser. The services, systems and appliances shown have not been tested and no guarantee as to their operability or efficiency can be given.

Made with Metropix ©2025

